



Age-Friendly Futures Summit

25 - 27th March 2025
Manchester



**Manchester
Metropolitan
University**



**Centre for
Ageing Better**



**WHO Global Network
for Age-friendly Cities
and Communities**

**MANCHESTER
1824**

The University of Manchester

**GREATER
MANCHESTER**
DOING AGEING DIFFERENTLY

Welcome

Welcome to the Age-Friendly Futures Summit.

The summit is bringing together over 200 leaders, policymakers, practitioners and researchers, from the UK and around the globe through a series of interconnected events over three days.

Fifteen years on from the launch of the Global Network of Age-friendly Cities and Communities, we are bringing together some of the latest thinking in Age-friendly research, policy and practice. Built around the themes of Advancing, Leading and Creating, we will be drawing attention to the future and how emerging challenges might be met. We invite you to learn, and share your own experiences, to make connections with us and others, and hope in turn you will feel inspired.

The Age-Friendly Futures Summit is delivered by a partnership of the Centre for Ageing Better, World Health Organisation, Greater Manchester Combined Authority, Manchester Metropolitan University and University of Manchester.

Each of the partners has been involved in curating different days and elements of the summit using their work and expertise as a stepping off point for discussion. We hope you enjoy your time with us.



**Natalie
Turner**
Centre for
Ageing Better



**Thiago
Hérick de Sá**
World Health
Organisation



Patty Doran
Manchester
Urban Ageing
Research
Group, UoM



Stefan White
Architecture
Research
Office, MMU



Paul McGarry
Greater
Manchester
Combined
Authority

The Partners



WHO Global Network
for Age-friendly Cities
and Communities

The WHO has supported the Global Network for Age-friendly Cities and Communities since 2010, to help cities and communities by showing what can be done and how it can be done, connecting cities and communities worldwide to facilitate the exchange of information, knowledge, and experience.

**GREATER
MANCHESTER**
DOING AGEING DIFFERENTLY

Greater Manchester has been a national and world leader in the development of age-friendly research, policy and practices, and has been recognised as such by the World Health Organisation. Fostering strong age-friendly ecosystem which includes academic leadership on Age-friendly through the University of Manchester and Manchester Metropolitan University.

 **Centre for
Ageing Better**

Centre for Ageing Better is a national charitable foundation which aims to tackle inequalities in ageing. The centre supports the UK Network of Age-friendly Communities with over 90 members covering a population of 29.6 million. The Centre's State of Ageing report is the most comprehensive of its type, with data and analysis to increase understanding of the latest and most significant issues facing older people in England.



**Manchester
Metropolitan
University**

The Advanced & Applied Architecture Research Office at Manchester Metropolitan University (ARO@MMU) focuses on designing and evaluating systems and urban interventions for spatial justice and health equity. For over 15 years, our interdisciplinary research has promoted age-friendly neighborhoods across Greater Manchester through policy and community engagement.

MANCHESTER
1824

The University of Manchester

The Manchester Urban Ageing Research Group (MUARG) at the University of Manchester uses collaborative approaches to investigate how population ageing intersects with urban change. Their research includes addressing inequalities, experiences of living in areas of deprivation and examining the impact of social exclusion on urban ageing. MUARG works across disciplines and aligns closely with the Healthier Futures Platform at the university.

Table of Contents

Overview programmes	5
.....	
Tuesday 25 March session detail	10
.....	
Wednesday 26 March session detail	17
.....	
State of Ageing launch event	37
.....	
Thursday 27 session detail	40
.....	
Floor plan	52
.....	

Click on one of these titles to jump to the relevant page



**Age-Friendly
Futures Summit**

Overview

Tuesday 25th March

10:45 **Event arrivals**

11:15 **Summit opening**
White room

11:30 **Advancing spatial justice in age-friendly work**
White room

12:30 **Lunch**

13:15 **Parallel sessions: A global survey of age-friendly futures research**

- Future age-friendly cities: Towards sustainable and just urban ageing - *White room*
- Co-creating inclusive age-friendly cities: Research across disciplines and sectors - *Connect room*

15:00 **Break**

15:30 **The Global Age-Friendly Research Challenge: Co-creating Research – advancing age-friendly research futures**
White room

17:00 **Close, next steps**
White Room

17:30 **Day ends**

Overview

Wednesday 26th March AM

9:00

Event arrivals

9:30

Plenary panel

Elliot Suite

10:00

Building leadership through cross-system collaboration

Elliot Suite

10:55

Break

11:15

Building leadership through supporting the voice and meaningful engagement of people in mid and later life

Elliot Suite

12:00

Building leadership through economic growth and development

Elliot Suite

Overview

Wednesday 26th March PM

13:00

Lunch and arrival of UK Network of Age-Friendly Communities

Breakout sessions - first round

14:00

- Creating Age-friendly homes: Research, Policy and Practice - *White Room*
- Co-creating community-led responses for social connection - *Elliot Suite*
- Stronger together: uniting community, clinical and care for falls prevention - *Boardroom*
- Age-friendly employment - *Connect Room*
- Walking audits to create age-friendly environments - *Training room*

15:00

Break

Breakout sessions - second round

15:30

- Creating Age-friendly homes: Research, Policy and Practice - *White Room*
- Co-creating community-led responses for social connection - *Elliot Suite*
- Mature Minds Matter: Enhancing and improving access to Mental Health Support for Older People - *Training Room*
- Age-friendly employment - *Connect Room*
- Walking audits to create age-friendly environments - *Gaskell Room*
- Shaping the Future of Healthy Ageing: The WHO European Strategy on Ageing is Living - *Boardroom*

16:30

Break to walk over to Manchester Hall

17:00

State of Ageing Launch event

Manchester Hall, 36 Bridge Street

18:25

Networking drinks reception

Manchester Hall, 36 Bridge Street

Overview

Thursday 27th AM

9:00

Event arrivals

9:30

Opening of UK Network Conference

Elliot Suite

9:40

Welcome to Manchester

Elliot Suite

9:50

Understanding differing experiences of ageing

Elliot Suite

11:00

Break

Breakout sessions - Morning

11:20

- Creating age-friendly businesses - *White Room*
- Dying well in Age-friendly Communities - *Training Room*
- Building Age-friendly and Inclusive Rural Communities - *Boardroom*
- Getting started with working with older residents - *Connect Room*

12:20

Lunch

Overview

Thursday 27th PM

12:20

Lunch

13:00

Networking session

14:00

Break

Breakout sessions - Afternoon

14:00

- Understanding the impact of your age-friendly community - *Boardroom*
- Mapping your community's age-friendliness - *White Room*
- Becoming an Age-friendly leader - *Training Room*
- Taking your co-production work to the next level - *Connect Room*

15:30

Celebrate Ageing, Challenge Ageism

Elliot Suite

15:55

Wrap up and Close

Elliot suite

16:15

Conference ends

Tuesday 25 March

Advancing Age-Friendly Futures through research

This day is led by Manchester Metropolitan University (Architecture Research Office) and University of Manchester (Manchester Urban Ageing Research Group). It will reflect on the rationale for age-friendly work and consider how research can advance action by partnering with policy makers and older citizens to make urban environments better places to grow old. Below you can find a list of the speakers and sessions that will take place today.

Summit opening

White Room

Welcome from GMCA, on behalf of the summit partners: the WHO, the UK Centre for Ageing Better, Manchester Metropolitan University and the University of Manchester. Introducing the conference themes of advancing, leading, and creating Age Friendly Futures

Paul McGarry

Assistant Director of Public Service Reform and
Head of the GM Ageing Hub, GMCA

Paul McGarry, head of GMCA's Ageing Hub since 2016, is Assistant Director of GMCA's Public Service Reform Directorate. Paul is a founding member of WHO's Global Network and the UK Network of Age-Friendly Cities and Communities, and a research fellow at Manchester University. He has been honoured with the "United Nations Healthy Ageing 50" title and the British Society of Gerontology's "Outstanding Achievement Award" for his significant contributions to gerontology.



Key issues for advancing age-friendly futures in research and policy implementation. Presentations setting out two principal challenge areas:

- Understanding and creating places for equitable urban ageing. Exploring the challenges of designing, implementing and evaluating Age Friendly Cities and Communities programmes.
- Exploring how a 'spatial justice' lens can advance age-friendly work, highlighting the importance of redistributing resources, amplifying diverse voices, and fostering co-production to create more inclusive and equitable age-friendly communities.



Paul McGarry

Assistant Director of Public Service Reform and Head of the GM Ageing Hub, GMCA

See above



Stefan White

Professor of Architecture, Director of Advanced and Applied Architectural Research Office (ARO), Manchester Metropolitan University (MMU)

Stefan White is a Professor of Architecture at the Manchester School of Architecture, Manchester Metropolitan University. He directs A3RO, focusing on interdisciplinary architectural research addressing global challenges like population ageing, urbanisation, and health inequity. He leads the Design for Life consultancy with Pozzoni Architecture and heads the Healthy Ageing Collaboration group at MMU.



Tine Buffel

Professor of Sociology and Social Gerontology & Director of Manchester Urban Ageing Research Group (MUARG)

Tine Buffel, a Fellow of the Academy of Social Sciences and Professor at the University of Manchester, directs the Manchester Urban Ageing Research Group. Her work focuses on social and environmental issues related to ageing, especially inequality, exclusion, and justice. Known for her participatory research methods, she works with older people, local authorities, and communities to create age-friendly environments.

A global survey of age friendly futures research

Paralell sessions

Panel 1: Future age-friendly cities: Towards sustainable and just urban ageing

White Room

This session will push the debate on age-friendly cities and communities forward by addressing:

- How cities can be future proofed against climate, economic, and demographic change.
- The role of spatial justice in ensuring age-friendly policies benefit all older adults equitably.
- Strategies for sustainable urban design that enhance the resilience of ageing populations.
- Current research gaps and the future of age-friendly research.

Dr Mark Hammond

Senior Lecturer, Manchester Metropolitan University (MMU), Manchester School of Architecture (MSA)

Dr. Mark Hammond is the Deputy Research Lead at Manchester School of Architecture. His research examines architecture and urban ageing, focusing on housing inequality and spatial justice. From 2018-2021, he was seconded to the GM Ageing Hub to help develop their Housing, Planning and Ageing programme. He currently leads the 'Co-Creating Age-Friendly Social Housing' project.

Ryan Woolrych

Professor in Ageing and Urban Studies, Heriot Watt University

Ryan Woolrych is a Professor in Ageing and Urban Studies at Heriot-Watt University, focusing on inclusive supports for healthy ageing. He leads cross-national research on age-friendly cities, especially in the Global South with case studies in India, Brazil, and Colombia, using participatory methods to study ageing and place. Professor Woolrych has secured major UK research funding and currently researches place-based inequalities among Roma populations.



Chair





Dr Emi Kiyota

Associate Professor, National University of Singapore

Dr. Emi Kiyota, an environmental gerontologist with over 20 years of experience, specializes in person-centered care and transforming organizational culture in long-term care facilities worldwide. She founded Ibasho in 2010 to create elder-led community hubs in Japan, Nepal, and the Philippines. Collaborating with the World Bank and WHO, she works on improving aging services in low-middle income countries. Her areas of focus include socially integrated cities, aging in place, brain health design, and aging's intersection with climate change.



Judith Phillips

Professor of Environmental and Social Gerontology, University of Stirling

Judith Phillips is Professor of Social and Environmental Gerontology at the University of Stirling. Between 2020 and 2024 she was the UKRI Research Director for the Healthy Ageing Challenge, held alongside her position as Deputy Principal (Research) at the University. She has published and researched widely on environmental aspects of ageing, social care and caregiving. In 2013 she was awarded an OBE for Services to Older People.



Dr Beatriz Fernandez

Associate Professor, Urban Studies, The School of Advanced Studies in Social Sciences (EHESS), Paris

Beatriz Fernández, an urban planner and Associate Professor at EHESS in Paris, researches demographic shifts in cities, focusing on aging, urban change, and planning policy. She leads two projects: EnversMet (funded by ANR) studies population aging and age-friendly policies in Paris and Madrid; SeniorSolitude (funded by Paris) compares strategies to address loneliness among older adults in Paris, Sapporo, Montreal, Toronto, and Madrid. She was a visiting scholar at Doshisha University in autumn 2024.



Dr Jo-Pei Tan

Senior Lecturer, Integrated Health and Social Care, MMU

Dr. Jo-Pei Tan, Senior Lecturer in Integrated Health and Social Care at Manchester Metropolitan University, has over 20 years of experience in applied psychology and public health. Specialising in intergenerational ties and care relations, she holds a DPhil in Evidence-based Social Intervention. Her research on equitable aging uses innovative methods to address health inequalities and care provision challenges. Dr. Tan's interdisciplinary work has earned her recognition as a keynote speaker for the British Society of Gerontology's 2025 Annual Conference.

Panel 2: Co-creating inclusive age-friendly cities: Research across disciplines and sectors

Connect Room

This session will critically examine who benefits from age-friendly policies, who is excluded, and how research can drive meaningful change, ensuring that age-friendly cities are co-created with, rather than just for, diverse older populations.

This session will address:

- How urban design and infrastructure shape the inclusion or exclusion of ageing populations.
- Strategies for co-production and participatory design to ensure diverse voices are heard.
- The psychological and cognitive dimensions of ageing in diverse urban settings.
- Current research gaps and the future of age-friendly research.



Prof Stefan White

Professor of Architecture, Director of Advanced and ARO, MMU

See above



Prof Joost van Hoof

Professor of Urban Ageing, Faculty of Social Work & Education of The Hague University of Applied Sciences

Joost works as a full professor of Urban Ageing with the Faculty of Social Work & Education of The Hague University of Applied Sciences in The Netherlands. Since December 2017, he has also been affiliated with the Department of Systems Research of Wrocław University of Environmental and Life Sciences in Poland. Professor Van Hoof is the Chairperson of the Knowledge Platform Age-friendly The Hague, which conducts the bi-annual assessment of the age-friendliness of the city for the municipality.

Rahimah Ibrahim

Associate Professor, Malaysian Research Institute on Ageing (UoM)



Rahimah Ibrahim is a prominent gerontologist and aging policy expert, leading the Malaysian Research Institute on Ageing (MyAgeing®) at Universiti Putra Malaysia. She influences Malaysia's aging policies through her roles in the National Councils on Ageing and SUHAKAM. As Deputy Chairman of KENDANA and Deputy President of the Gerontological Association of Malaysia, she advocates for caregiver rights and interdisciplinary collaboration. Her initiatives focus on age-friendly cities and aging-in-place solutions. Dr. Rahimah promotes intergenerational solidarity and integrated health-social care, guiding evidence-based policy development and sustainable strategies for future generations.

Neil Dagnall

Professor in Applied Cognitive Psychology, MMU



Professor Neil Dagnall researches applied cognitive psychology, focusing on how people process information, make decisions, and respond to uncertainty. His work examines cognitive factors influencing memory, reasoning, and behaviour change, with applications in performance, wellbeing, and risk assessment. He explores how individuals evaluate information across contexts to enhance adaptive decision-making. His research applies psychology to real-world settings, including education, health, and occupational performance. Neil also studies lived space, contributing to projects that improve housing choices for older adults and inform urban planning.



Nicola Waterworth

Strategic Lead - Ageing in Place at GMCA

Nicola Waterworth leads the Ageing in Place Pathfinder in Greater Manchester and works on Greener Later Life for the Ageing Hub. She has extensive experience in fostering partnerships between the public, VCFSE, and private sectors, incorporating residents' voices and building community capacity to address inequalities. Before joining GMCA, Nicola worked in policy, strategy, commissioning, project delivery, and managing transformational programs in local government and as a consultant.



Niamh Kavanagh

Research Associate, UoM

Niamh Kavanagh earned a PhD in Sociology in 2022 and is now a Research Associate at UoM's Department of Architecture. Her research explores how housing, cities, gentrification, urban change, place, and materiality affect people's lives. She uses participatory, ethnographic, and longitudinal methods with a focus on social justice and time. Her current project, 'Over-researched but invisible,' examines the effects of over-research on a marginalised community near Manchester Universities through co-creation.

The Global Age-Friendly Research Challenge: Co-creating Research – advancing age-friendly research futures

This final session will take the form of facilitated discussions consolidating conversations from throughout the day.

How can we move the agenda forward? Discussing new areas, networks, and interdisciplinary collaborations in small groups.

The output from this session will be to draft a summit statement to be published as a letter or short communication: Age-Friendly Futures Network.

Wednesday 26 March

Leading and creating through policy and practice

Led by the Greater Manchester Combined Authority, this day explores the leadership and practical action that is needed to create age-friendly cities and city regions, by showcasing the work from Greater Manchester.

9:30 - 10:30: Plenary panel

Elliot Suite

This plenary will welcome attendees to Greater Manchester and set out the importance of age-friendly work to city regions and other subnational actors. As an introduction to the day and its themes, the panel will also provide an overview of the Greater Manchester experience of building an ecosystem and taking forward the age-friendly agenda.

Lynne Ridsdale

Chief Executive (Bury Council) and Greater Manchester Portfolio Lead for Equalities Lead - Ageing in Place at GMCA

Lynne is CEO of Bury Council; place lead for gm NHS services in Bury and GM portfolio lead for equalities. Lynne led the development of the Bury community strategy – LETS do it! – a call for public, private and community sectors to work together and improve the lives of local people. Lynne is an HR professional by background and a fellow of the cipd; committed to equalities, she was formerly vice chair of a major GM charity supporting disabled people.





Dr Thiago Herick de Sa

Technical Officer, Age-friendly Environments,
World Health Organisation, Geneva

Thiago began his career as a physical educator for older adults in Brazil's healthcare settings. Since 2010, he has been a researcher in Brazil and the UK, publishing in major journals. He joined WHO in 2017 to support urban, transport, and health initiatives. In 2022, he started leading Age-friendly environments at WHO, coordinating the Global Network for Age-friendly Cities and Communities, developing national program guides, and supporting WHO Member States.



Sir Richard Leese

Chair, NHS Greater Manchester Integrated Care
Board

Sir Richard signed the city-region's health devolution deal in 2015. He led Greater Manchester Health and Social Care Partnership from March 2020 before chairing NHS Greater Manchester Integrated Care. He has also chaired Manchester's Health and Wellbeing board, Manchester, Salford, and Trafford Health Action Zone, addressing health inequalities. A strong advocate for addressing the determinants of health, Sir Richard believes partnership working is key to this and public service reform. He co-chairs Greater Manchester Integrated Care Partnership.

Building leadership through cross-system collaboration

Elliot Suite

This panel will set out the key features of developing cross-sectoral collaboration at a city regional level, including what the experience of this is for individual actors. The panel will discuss the added value of developing cross-system collaboration for institutions and for people within the region. Paul McGarry will share learning from working in partnership with Centre for Ageing Better, and panellists will discuss how change can be created by using a cross-system approach.



Chair

Paul McGarry

Assistant Director of Public Service Reform and Head of the GM Ageing Hub, GMCA

Paul McGarry, head of GMCA's Ageing Hub since 2016, is Assistant Director of GMCA's Public Service Reform Directorate. Paul is a founding member of WHO's Global Network and the UK Network of Age-Friendly Cities and Communities, and a research fellow at Manchester University. He has been honoured with the "United Nations Healthy Ageing 50" title and the British Society of Gerontology's "Outstanding Achievement Award" for his significant contributions to gerontology.



Prof Tine Buffel

Professor of Sociology and Social Gerontology & Director of Manchester Urban Ageing Research Group (MUARG), University of Manchester (UoM)

Tine Buffel, a Fellow of the Academy of Social Sciences and Professor at the University of Manchester, leads the Manchester Urban Ageing Research Group. She focuses on ageing, inequality, and social justice, using participatory methods to work with older people, local authorities, and community groups to create age-friendly environments.



Prof Stefan White

Professor of Architecture, Director of Advanced and Applied Architectural Research Office (ARO), Manchester Metropolitan University (MMU)

Stefan White is a Professor of Architecture at the Manchester School of Architecture, Manchester Metropolitan University. He directs A3RO, focusing on interdisciplinary architectural research addressing global challenges like population ageing, urbanisation, and health inequity. He leads the Design for Life consultancy with Pozzoni Architecture and heads the Healthy Ageing Collaboration group at MMU.



Dr Thiago Herick de Sa

Technical Officer, Age-friendly Environments,
World Health Organisation, Geneva

See above.



Leesa Hellings-Lamb

Public Health Specialist, Age Well and Wider
Determinants (Bolton Council)

Leesa Hellings-Lamb is a Public Health Specialist at Bolton Council, Greater Manchester leading on Age Well and Wider Determinants of Health. As a clinician Leesa has worked in health, social care and the voluntary sector, in the UK, Africa and Asia, with experience across the life course. Her passion and enthusiasm remain firmly focused on ageing well, empowering individuals and communities to age well and live healthy, active, independent and fulfilling lives.



Anne Berit Rafoss

Project Manager, Centre for an Age-Friendly
Norway

Anne Berit Rafoss has promoted age-friendly development for 12 years. She developed Oslo as an age-friendly city, led a working group on "Urban Ageing" in Eurocities, and worked at WHO Geneva on age-friendly projects. She created a network of age-friendly cities in Norway, currently hosted by the Centre for an Age-Friendly Norway/Norwegian Directorate of Health. As project manager, she oversees the national network and international affairs, focusing on older people's involvement, cross-sector collaboration, and sustainable development.

This panel will consider the different levels of leadership within an age-friendly ecosystem, and the varying ways in which older people lead and participate in age-friendly work.

This includes a short interview with Elaine Unegbu, Chair of Age-Friendly Manchester Older People's Board and the Greater Manchester Older People's Network, followed by a discussion around good practice, challenges and gaps.



Chair

Natalie Turner

Deputy Director for Localities, Centre for Ageing Better

Natalie aims to create better living conditions for older adults. Her team collaborates with Greater Manchester, Leeds, and Lincolnshire, and supports the UK Network of Age-friendly Communities, an affiliate of the WHO's Global Network for Age-friendly Cities and Communities. Since 2010, she has worked on ageing issues locally, nationally, and internationally. She previously worked at AARP in Washington, DC, and Age UK London, translating international practices for a US audience.



Elaine Unegbu

Chair, Age-Friendly Manchester Older People's Board

Elaine is dedicated to ensuring older people's voices are heard and respected. She chairs the Age Friendly Manchester Older People's Board and the Greater Manchester Older People's Network Steering Group, and participates in various organizations like Ageing Better's Experts by Experience Network. Elaine advocates for the recognition and inclusion of older people's perspectives in decision-making.



Nicola Waterworth

Strategic Lead - Ageing in Place at GMCA

Nicola Waterworth leads the Ageing in Place Pathfinder and works on Greener Later Life for the Ageing Hub. She has extensive experience in fostering partnerships between the public, VCFSE, and private sectors, incorporating residents' voices and building community capacity to address inequalities. Before joining GMCA, Nicola worked in policy, strategy, commissioning, project delivery, and managing transformational programs in local government and as a consultant.



Julia Peterbauer

International Relations Officer, Vienna Social Fund

Julia Peterbauer joined Vienna's older people's representative in 2013, providing counselling and policy work. She later managed and modernised the Contact Visit Service. In 2018, she moved to international relations for the Vienna Social Fund, representing the city in EUROCITIES Social Affairs Forum and vice-chairing the Wellbeing & Ageing working group until 2023.



Tom van Bentham

Strategic Policy Advisor, Amsterdam

Tom was born in 1976, studied at the university of Amsterdam, now a Master in political science. He has worked 5 years at the regional level of the province of Noord-Holland supporting cities in their policy tasks in the field of youth and well being. Now Tom is a strategic policy advisor at the public health department of the city of Amsterdam. Advisor to management and politicians on public health, including urban ageing and HIV/AIDS. Involved with the reference city of the Amsterdam metropolitan area since 2016. Chair of the working group urban ageing at Eurocities, an organisation representing cities larger than 250,000 inhabitants in Europe.

This panel will investigate the strategies that age-friendly programmes can adopt to speak to economic growth and development agendas.

Panellists will discuss the economic opportunities of ageing populations for city regions, as well as key priorities around ageing and innovation. This panel will identify strategic drivers and discuss how to position ageing work within economic and development opportunities for cities and city regions.

Dr Emily Andrews

Deputy Director for Work, Centre for Ageing Better

Emily leads the Work team at Ageing Better, focusing on fair work access for people aged 50+. They manage the Age-friendly Employer Pledge network of over 450 employers. They collaborate with employment support providers, local commissioners, and policy-makers to promote system change, including evaluating Working Well: Support to Succeed with GMCA. Previously, Dr. Andrews was Associate Director at the Institute for Government, studying public service spending constraints post-2010. She holds a PhD in History from the University of Warwick and began her career as a secondary school teacher.



Chair

David Sinclair

Chief Executive, International Longevity Centre – UK

David has 20 years of experience in policy and research on ageing and demographic change. He focuses on older consumers, active ageing, financial services, adult vaccination, and technology in ageing societies. David is knowledgeable about UK and global ageing issues, including healthcare, pensions, housing, and transport. He has been an expert for the pan-European Age Platform for 15 years and served as Vice-Chair of the Government's Consumer Expert Group for Digital Switchover. He also chaired a London charity (Open Age) for ten years, promoting physical and mental fitness among older people.





Andrea Winders

Head of Business Development, Manchester Inward Development Agency Service (MIDAS)

Andrea Winders is the Head of Inward Investment for Life Sciences and Healthcare at MIDAS. She promotes Greater Manchester as a prime location for life sciences investments, collaborating with international partners and governments. Andrea connects businesses with UK research bodies to support the development and commercialization of innovative products.



Prof Lynne Corner

Director, VOICE and COO, National Innovation Centre for Ageing (NICA)

Professor Lynne Corner is the Deputy Director of the UK National Innovation Centre for Ageing (NICA), working to leverage global longevity economies. She co-founded the Longevity Lab with Edelman and directs Voice®, an international community fostering innovation for healthier lives through citizen expertise. With over 30 years in healthy ageing and brain capital research, Lynne specializes in data and AI. She also co-leads the International Dementia Innovation Hub and is a Trustee of the Lewy Body Society.



Angela Harrington

Director of Inclusive Economy, Growth and Development (Manchester City Council)

Angela, Director of Inclusive Economy at Manchester City Council, leads the City's inclusive growth efforts, supporting businesses and connecting residents to employment opportunities. She oversees Manchester Adult Education Service (MAES) and prioritises ensuring local residents benefit from the City's growth, aligning with Manchester's goals of becoming a "highly skilled" and "fair and equitable city". The Covid pandemic had a significant economic impact on some businesses and residents, prompting Angela to lead the response for at-risk residents and develop the city's Anti-Poverty Strategy while contributing to the broader economic strategy.

Michael Hodin

Chief Executive Officer, Global Coalition on Ageing



Michael W. Hodin, Ph.D. is CEO of the Global Coalition on Aging, Managing Partner at High Lantern Group, and a Fellow at Oxford University's Harris Manchester College. He has spoken internationally on aging, including at G20, APEC, Davos, and the World Knowledge Forum. From 1976-80, Mike was Legislative Assistant to Senator Daniel Patrick Moynihan. He was a senior executive at Pfizer, Inc. for 30 years, where he created and led International Public Affairs and Public Policy operations. Mike holds a BA, cum laude, Cornell University, M.Sc. from The London School of Economics, and M.Phil and Ph.D. from Columbia University.

Breakout sessions

Creating Age-friendly homes: Research, Policy and Practice

White Room

In this session, we will explore how we can create more age-friendly homes in our cities and communities. The session is being organised by the GM Housing, Planning and Ageing group – an interdisciplinary task group aiming to improve the quality and quantity of age-friendly housing in Greater Manchester, UK. We will explore how cross-sectoral partnerships between researchers, policy-makers and built environment practitioners can better address the diverse housing needs of older people, using practical examples developed over the last 5 years. We will invite delegates attending to share examples of good practice, helping us to reflect on how the age-friendly movement can better support the creation of age-inclusive homes.

Mark Hammond

Senior Lecturer, Manchester Metropolitan University (MMU), Manchester School of Architecture (MSA)



Dr Mark Hammond is Deputy Research Lead at Manchester School of Architecture. His research focuses on the intersections between architecture and urban ageing within the home, community and city, with a specific interest in housing inequality and spatial justice. He was seconded to the GM Ageing Hub between 2018-2021 to support the development of their Housing, Planning and Ageing programme, and is currently the Principal Investigator on the 'Co-Creating Age-Friendly Social Housing', project.



Shannon Conway

Co-Founder, Picture This

Shannon co-founded Picture This, a residential developer focused on thoughtful design and long-term stewardship to offer better housing options and community benefits. They create sustainable, practical homes for all ages. Picture This Stockport, featuring 245 rental apartments and a community garden, will begin construction this year.

Nigel Saunders

Director, Pozzoni Architecture



Nigel is a director at Pozzoni Architecture, working nationally across a broad range of public sector, third sector and private sector clients. He oversees architectural and masterplanning work in the residential, later living, care and health sectors. He is particularly interested in designing environments for all-ages, inclusive of our ageing population's aspirations and needs. Nigel participates in the APPG on Housing and Care for Older People, contributes to various publications and also chairs GMCA's Housing, Planning & Ageing Group to promote best practices for age-inclusive living and housing quality across GM.

Kelly-Marie Rogers

Strategic Lead, Healthy Active Places (GM Moving)



Kelly-Marie is the Strategic Lead for Healthy Active Places at GM Moving. Kelly supports Greater Manchester's places and spaces to become healthier and more active: acknowledging the built environment's impact on our communities, enabling more active, healthy and sustainable lives for all. She is a qualified architect with a focus on equity. GMMoving is a shared movement for movement, utilising system-based approaches to create the conditions for active and healthy lives for all across Greater Manchester.



Steve Fyfe

Head of Housing Strategy, GMCA

Steve Fyfe joined AGMA in 2009 on a secondment and remained ever since. As the Greater Manchester housing agenda evolved, he worked with local authorities and Homes England to speed up new housing delivery. He led the development of the Greater Manchester Housing Strategy and is now focused on making Greater Manchester a 'Housing First' city region by 2038. Before AGMA, Steve worked on housing and planning for central Government in the North West.

Co-creating community-led responses for social connection

Elliot Suite

Join practitioners from Greater Manchester's social housing providers, civil society organisations and the Greater Manchester Combined Authority sharing their experiences of co-creation with residents in mid and later life. This interactive session will draw on examples from community-based work in the Greater Manchester Ageing in Place Pathfinder, community reporting from Talking About My Generation and the role of spatial data mapping and action planning.

Liz Windsor-Welsh

Chief Executive, Action Together



Liz Windsor-Welsh is the CEO of Action Together CIO, a civil society support organization in Oldham, Rochdale, and Tameside (Greater Manchester, UK). Action Together aims to strengthen civil society and create positive social change by collaborating with local people, community groups, and public/private partners. These areas boast a vibrant voluntary sector with over 3000 groups. Liz is also a Director of 10GM, a joint venture supporting the VCSE sector across Greater Manchester.

Miu Tsui

Age-Friendly Project Manager, Southway Housing



Miu Tsui is the Age Friendly Project Manager at Southway Housing Trust, overseeing the Ageing in Place Pathfinder Project in Manchester. Her expertise includes age-friendly community initiatives, collaboration, engagement with older adults, partnership building, and innovation. Previously, Miu worked at a university's Institute of Ageing on a city-wide project in Hong Kong, handling coordination, research, evaluation, and online resource development.



Amanda Aitken

Ageing in Place Development worker, Healthy Me Healthy Communities

Amanda Aitken coordinates the Age Friendly Drop-in Space at Healthy Me Healthy Communities (HMHC) in Gorton Central. She collaborates with local older people to create an enjoyable space that drives positive change in Gorton/Abbey Hey. After a successful career as a restaurateur, Amanda retrained as a Public Health Nutritionist, co-authored publications, and presented at conferences. She is committed to improving community health and wellbeing through diet.



Becky Earl

Age-Friendly Advisor, Rochdale Borough Housing

Becky Earl is the Rochdale Aging in Place Pathfinder across both the Kirkholt and Smallbridge estates. Becky is passionate about reducing inequality and empowering local people to enhance their community in which they live. Prior to this Becky has been a Wellbeing Project Manager within the NHS / local authority, and also a PA.



Kirsty Day

Media Director, Talking About My Generation

Kirsty is an experienced journalist and the media director of social enterprise, Yellow Jigsaw, who are community media specialists. She is the editor of the first older people's led newsroom - Talking About My Generation - covering news and views across Greater Manchester with and for those aged 50+ alongside the 15-strong volunteer news team. She brings her 14 years' experience in the industry to ensure all of our community media projects over the past 10 years meet industry standards. A passionate trainer and people-person, Kirsty supports everyone we work with to identify their strengths and build their confidence in working with the media.



Sandaru Weerasinghe

Lead Analyst, GM Ageing Hub, GMCA

Sandaru Weerasinghe is the Lead Analyst at the GM Ageing Hub and heads the Ageing in Place Pathfinder project. She manages spatial data for action planning by Pathfinder Partnerships. Holding a PhD in Urban Studies, her research focuses on the impacts of crime and safety perceptions, using digital technologies like virtual reality to explore human-environment interactions. Her goal is to support healthy city planning, emphasizing well-being and safety.

Stronger together: uniting community, clinical and care for falls prevention

Boardroom

Falls Prevention has been a key priority for Greater Manchester over the years, and we have made a significant shift in moving this agenda forwards. This interactive workshop will be a dedicated session to discuss with key leaders from across the system how we strengthen our existing collaboration to influence future policy and practice.

We will discuss how we build on the evidence-base, share best practice and integrated approaches to falls prevention, to enable older people in Greater Manchester to enjoy a longer, more independent, healthier life.

Prof Jane McDermott

NIHR Policy Research Unit Healthy Ageing,
University of Manchester



Jane's portfolio career includes working within the NIHR Policy Research Unit in Healthy Ageing and the NIHR Innovation Observatory. She leads on strategic priorities for collaboration, public and community involvement, knowledge mobilisation, and impact. With over 25 years of experience in health ageing, policy research, innovation, and social inclusion, Jane has led complex programmes and projects and fostered strategic partnerships. Her work extends across local, regional, national, and international landscapes, consistently advocating for equality, diversity, inclusion, and belonging.



Dr Nikesh Vallabh

GP and Clinical Director for Proactive Care, NHS GM

Nikesh Vallabh is a GP partner at South Wigan Medical Practice and the Clinical Director for SWAN Primary Care Network. He leads efforts to develop the Primary Care workforce in Greater Manchester, focusing on recruitment, retention, and training. Additionally, as the GM Proactive Care Clinical Lead, he works to improve patient outcomes through early intervention by integrated MDTs to address health inequalities.



Beth Mitchell

Ageing Well Programme Manager, GM Ageing Hub, GMCA

Beth Mitchell is the Ageing Well Programme Manager, as part of the GM Ageing Hub. As Ageing Well Programme Manager, Beth's work involves influencing the health and care system to look at system re-design to enable older people in Greater Manchester to age well in place. Some of the key thematic areas which Beth leads on are the development and implementation of the Greater Manchester Falls collaborative, mental health, physical activity, and women's health.



Prof Chris Todd

Professor of Primary Care & Community Health, UoM

Chris is the Director of the NIHR Older People & Frailty Policy Research Unit and leads the Healthy Ageing Theme at NIHR Applied Research Collaboration Greater Manchester. He previously led the Healthy Ageing Research Group until 2022. A NIHR Senior Investigator and Fellow of the Royal College of Physicians of Edinburgh, he has received grants from organizations like the Department of Health and Social Care, NHS, MRC, NIHR, and the European Commission. Chris has served on numerous research committees, reviewed for various bodies, and helped shape WHO policies on fall prevention for older adults.



Vincent Fraga

Assistant Director of Adult Social Care
Commissioning, Stockport Council

Vince has 35 years of experience in social and health care in the UK and US. Since 2004, he has worked for Stockport Council, now as Assistant Director in Adult Social Care. He focuses on prioritising people, especially older citizens, and promoting independence. Vince aims to offer choices and preventive measures, reduce reliance on formal services, and enhance community support. Dedicated to partnership across all sectors, he works to challenge organisational boundaries and drive collaboration.

Age-friendly employment

Connect room

Support to access work has not always been designed with people in their 50s, 60s and beyond in mind. With people being more likely to face additional challenges in finding and sustaining work as they age, Greater Manchester Combined Authority in partnership with Centre for Ageing Better have taken steps to understand what residents need and to look at how our approach to employment support services and wider activity can support this.

With a focus on those who are not in paid employment and may have barriers to work, we are looking at new ways to design and deliver employment related activity.

We will be sharing insights from our projects to date, looking at how we can turn ideas into embedded policy and practice at a local level.

Elaine Smith

Programme Manager, Centre for Ageing
Better/GMCA

Elaine is Ageing Better's Senior Programme Manager for 50+ Work, overseeing projects to improve employment and skills support for people aged 50 and over. She also collaborates with local government to enhance services and share insights regionally. This includes work with Greater Manchester Combined Authority on new engagement and employment support models.





Elayne Redford

Work and Skills Specialist, Manchester City Council

Elayne has worked in Economic Development for over 20 years, and she has a passion for supporting the most disadvantaged and marginalised to access the city's employment opportunities. Reducing inequalities and empowering people to fulfil their potential is a key driver in whatever work Elayne undertakes. Elayne is currently focused on projects that support the delivery of Manchester's Work & Skills Strategy and she works with partners from the public, private and voluntary sectors to achieve shared goals.

Jane King-Fahey

Supply Chain Manager, The Growth Company



Jane King-Fahey is a Supply Chain Manager for Support To Succeed (STS) in Greater Manchester, having joined in 2024. Previously, she worked on a program assisting at-risk youth with employment and education. Her transition from high school teacher to the welfare-to-work sector has led to significant achievements, including managing a successful supply chain for STS. Jane is dedicated to helping adults overcome barriers to lead fulfilling lives and aims to foster partnerships that support program participants in achieving their goals. Her commitment to making a positive impact is evident in her collaborative approach to supply chain solutions.

Walking audits to create age-friendly environments

Fully booked

Join us for a walking audit of Manchester City Centre, exploring how the physical environment shapes ageing in place. This interactive session will draw on insights from the Greater Manchester Ageing in Place Pathfinder, particularly the resident-led walking audits in Gorton, to highlight the importance of community-driven approaches in understanding and improving neighbourhoods for older residents.

By taking part, you will gain first-hand experience of how walking audits can inform inclusive urban design, learn from examples of co-creation with residents, and discuss practical applications with fellow practitioners, including community organisations, social housing providers, and local government. Spaces are limited to 12 participants.

Training Room
(first round)

Gaskell Room
(second round)



Chair

Lauren Foster

Project Manager, Ageing in Place Pathfinder, GM Ageing Hub, GMCA

Lauren Foster is the Project Manager for the Ageing in Place Pathfinder within the GM Ageing Hub. Her primary focus is around co-ordinating and delivering the Ageing in Place Academy and Pathfinder Visits, supporting Pathfinders and delivering on the programme plan with a key focus on sustainability, green outdoor spaces and digital. Lauren worked in nutrition and public health ageing for 10 years before joining the Ageing Hub.



Louise Robbins

Strategic Lead, Walking & Active Environments (GM Moving)

Louise Robbins works for GM Moving, the Active Partnership for Greater Manchester. Her focus is on advocating for the creation of inclusive active environments and involving people and communities in that work. Louise aims to influence and support the system and cultural changes required to create the conditions for people to walk, wheel and cycle in their neighbourhoods.



Helen Hawes

Community Engagement Assistant, Ageing in Place, Southway Housing

Helen Hawes is the Community Engagement Assistant at Southway Housing, working on the AIP pathfinder project in Abbey Hey and Gorton. She collaborates with older adults to develop environments and activities for positive ageing in place and facilitates community walking groups and age-friendly initiatives. With a background in education and social work, Helen is passionate about community engagement and fostering positive relationships for co-production.

Mature minds matter: Enhancing and improving access to mental health support for older people

Fully booked

Training Room

Mental health conditions among older people are often under-recognised, undertreated and the stigma surrounding these conditions can make people reluctant to seek help. In Greater Manchester, we are working across the system to challenge ageism and stigma around this, and as part of this workshop we will hear from system leaders in relation to the Mental Health and Wellbeing agenda for Greater Manchester, including the voice and lived experience from older people.



Chair

Lynzi Shepherd

Assistant Director of Mental Health Strategic Commissioning, NHS GM

Lynzi Shepherd is an NHS Assistant Director, overseeing mental health commissioning in Greater Manchester. She focuses on empowering people with lived experience and collaborating with VCSE organisations to enhance services. Lynzi aims to reduce out-of-area placements and improve community-based support, ensuring access to high-quality mental health care for older adults and communities. She works with system partners to drive meaningful, community-focused improvements.

Kathryn Dykes

Consultant Clinical Psychologist, Greater Manchester Mental Health (GMMH)

Kathryn has dedicated her career to working with older adults in various settings, advocating for accessible mental health support and ensuring their voices are heard. She is a Consultant Lead Clinical Psychologist at GMMH and the Older Adult Clinical and Care Professional Lead for Greater Manchester. Kathryn co-leads a national workstream on trauma and complexity in older people with the British Psychological Society. She has presented nationwide on age equality and supporting older adults with complex emotional needs and currently leads a project on eating disorders in older people in Greater Manchester.



Polly Kaiser

Semi-Retired Clinical Psychologist



Polly Kaiser is a semi-retired clinical psychologist specializing in older individuals and their carers since 1984. She served as the National Lead for Mental Health in Later Life at the NMH DU and has been an active member of the Faculty of Psychology of Older People (FPOP). Polly has conducted workshops on ageing awareness, diversity, sexuality, and bereavement. Currently, she supports Greater Manchester Mature Minds Matters, advising NHS and aging initiatives. As an advocate for age equality, Polly now represents older women, including herself.

Luke Jordan

Clinical Lead, Compass Manchester (Later Life Complex Emotional Needs/Personality Disorders Pathway), GMMH



Luke Jordan leads Compass Pathway, a service for older adults with complex emotional needs. He supervises and trains in Structured Clinical Management and practices Mentalisation Based Treatment, Schema Focused Therapy, and Radically Open Dialectical Behaviour Therapy. Luke focuses on supporting older adults with emotional needs or autism and researches treatments for those with high self-control.

Shaping the future of healthy ageing: The WHO European strategy on ageing is living

Fully booked

Boardroom

The planned WHO European Strategy on **Ageing is Living: Promoting Lifelong Health and Well-being (2026–2030)** envisions a future where everyone can age with dignity, living longer and healthier lives.

This table based discussion session, co-organized by WHO Europe will directly contribute to the development of the Strategy.

Yongjie Yon

Technical Officer on Ageing and Health, WHO Europe

Dr. Yongjie Yon is a Technical lead for the Ageing and Health unit at the WHO Regional Office for Europe in Copenhagen, Denmark. Dr. Yon was a Doctoral Fellow with the Social Sciences and Humanities Research Council of Canada and received his PhD in Gerontology from the University of Southern California, United States. Prior to WHO, Dr. Yon worked for the Government of Canada on ageing policies.

Prof Peter Kelley

OHID Regional Director and NHS Director of Public Health - North East and Yorkshire

Peter directed Public Health for Stockton-on-Tees Borough Council (2012-2016) and previously held similar roles in Teesside and North East England for 11 years. He has a PhD in statistics and started as a lecturer at Newcastle University before directing a health research unit at Teesside University. Focused on health inequalities, Peter led major public health programs. During the COVID-19 pandemic, he headed the public health response for the North East and Yorkshire, receiving the Faculty of Public Health's Presidents gold medal for his leadership.



Chair



WHO Global Network
for Age-friendly Cities
and Communities

State of Ageing Launch Event

Manchester Hall, 36 Bridge Street

Goulburn Suite,
Manchester Hall

Expert panel launching Centre for Ageing Better's flagship report examining inequalities in the way we age.

Dr Carole Easton

Chief Executive, Centre for Ageing Better

Carole has an extensive voluntary sector career, starting as a mental health practitioner. She served as Interim Chief Executive at Refuge and the British Lung Foundation, and Chief Executive at the Young Women's Trust and ChildLine. Her PhD focused on violence against children. Carole is an experienced non-executive director, Trustee, and Chair, currently on the Board of New Horizon Youth Centre.

Elaine Unegbu

Chair, Age-Friendly Manchester Older People's Board

Elaine is dedicated to ensuring older people's voices are heard and respected. She chairs the Age Friendly Manchester Older People's Board and the Greater Manchester Older People's Network Steering Group, and participates in various organizations like Ageing Better's Experts by Experience Network. Elaine advocates for the recognition and inclusion of older people's perspectives in decision-making.

Dr Jeanelle de Gruchy

Deputy Chief Medical Officer for England and lead for the Office of Health Improvement and Disparities

Dr. Jeanelle de Gruchy became England's Deputy Chief Medical Officer in October 2021, aiding the Chief Medical Officer on health improvement and inequalities. She leads the Office for Health Improvement and Disparities. Previously, she served as Director of Public Health for Tameside and Haringey councils and was President of the Association of Directors of Public Health from 2017 to 2021. Dr. de Gruchy trained clinically in South Africa and worked there and in the NHS.



Chair





Dr Aideen Young

Senior Evidence Manager – Research Impact and Voice, Centre for Ageing Better

Aideen plays a crucial role in Ageing Better's evidence function, ensuring they have the right data to support the organisation's work. She oversees the State of Ageing report and has led projects on active travel, strength training, community contributions, housing experiences during the pandemic, retirement transitions, and psychosocial support in later life. Aideen holds an MSc in Ageing and Society from King's College London and a PhD in Chemistry from New York University. She previously worked in medical communications and as a protein crystallographer.

Prof. Carol Holland

Director, Centre for Ageing Research, Lancaster University



Carol Holland is a Professor in Ageing at Lancaster University, UK, and Director of the Centre for Ageing Research. She is President of the British Society of Gerontology and focuses on cognitive and health psychology related to ageing and frailty. Her research includes reducing risk factors for frailty, cognitive decline, and dementia. She leads several projects on frailty, COVID-19 impacts, and active engagement in later life, and heads the Cognitive Frailty interdisciplinary network.



Directions to the venue

Following the breakouts in the afternoon, we will be moving to a nearby venue, Manchester Hall for the evening launch of the State of Ageing report. Below is a map directing you from one venue to the other, we will also have members of staff along the journey to help guide the way.

Manchester Hall

36 Bridge Street,
Deansgate,
Greater Manchester
M3 3BT

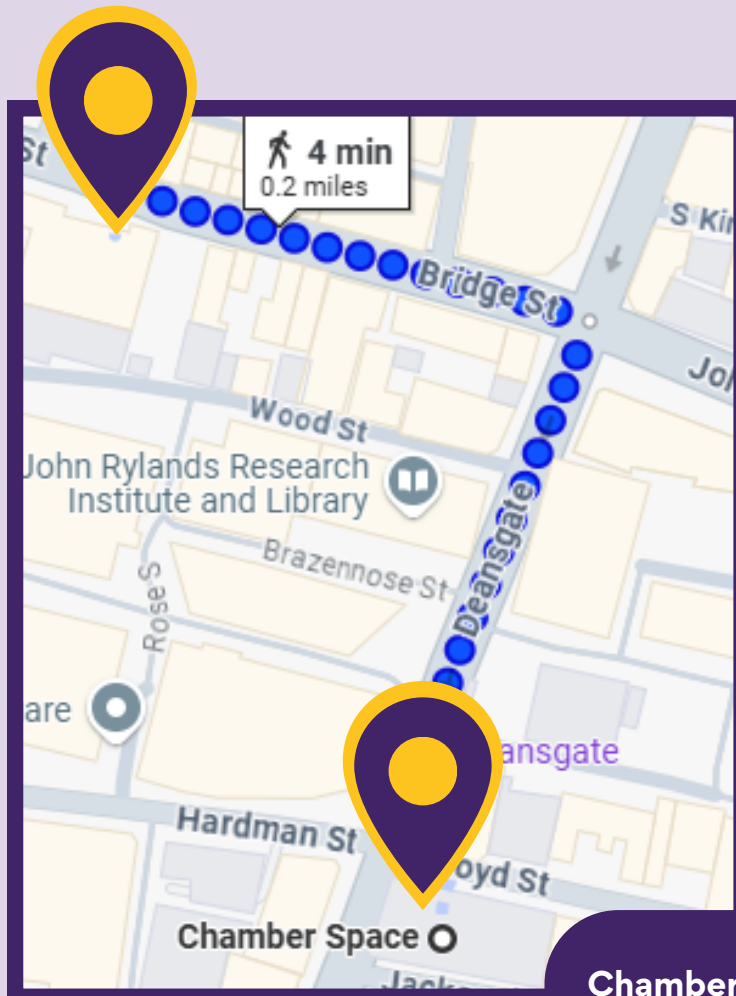

Chamber of Commerce



Thursday 27 March

UK Network of Age-Friendly Communities Conference

Led by Centre for Ageing Better, today opens the 6th annual conference of the UK Network of Age-friendly Cities and Communities.

Opening of UK Network Conference

Elliot Suite

Introduction to the 6th UK Network of Age-friendly Communities Conference.

Dr Carole Easton

Chief Executive, Centre for Ageing Better



Carole has an extensive voluntary sector career, starting as a mental health practitioner. She served as Interim Chief Executive at Refuge and the British Lung Foundation, and Chief Executive at the Young Women's Trust and ChildLine. Her PhD focused on violence against children. Carole is an experienced non-executive director, Trustee, and Chair, currently on the Board of New Horizon Youth Centre.

Welcome to Manchester

Elliot Suite

Opening remarks and a welcome to Manchester.

Councillor Tom Robinson

Executive Member for Healthy Manchester and Adult Social Care, Manchester City Council

Tom, a born and bred Mancunian, was elected to Manchester City Council in May 2021 and joined the Cabinet in 2022 as Executive Member for Healthy Manchester and Adult Social Care. After working in London's charity sector, he returned to Manchester in 2013 to work with the office of Tony Lloyd, Interim Greater Manchester Mayor. Tom later served as Parliamentary Assistant to Jonathan Reynolds MP and Executive Business Manager to the Leader of Tameside Council before joining the City Council Cabinet.



Understanding differing experiences of ageing

Elliot Suite

Ageing is not a universal experience – someone's identity and lived experience can make a significant impact on their ability to age well and access a supportive environment. This panel will explore the experiences of LGBT+ older people, people ageing with learning disabilities (and older carers) and older refugees and asylum seekers. The panel will discuss the unique challenges these groups are facing, the commonalities and differences in their experiences and the policy implications.

Dr Carole Easton

Chief Executive, Centre for Ageing Better

See above.



Chair

Lawrence Roberts

Pride in Ageing Manager, LGBT Foundation

Lawrence Roberts (he/him) manages Pride in Ageing, LGBT Foundation's programme for LGBTQ+ individuals over 50. His efforts highlight the voices of LGBTQ+ seniors in Greater Manchester. He is launching a new events programme in Liverpool and working on a national LGBTQ+ awareness accreditation for social care and housing professionals, called the Pride in Practice - Care Award. Lawrence's work has been featured in The Guardian, BBC News, Gaydio, BBC Radio, and Nursing Older People journal.





Christine Towers

Director, Together Matters

Christine has over 35 years of experience working with people with learning disabilities and their families. She has extensive experience in the not-for-profit sector and health and social care services, focusing on service development and management. In 2016, she founded Together Matters to create resources and support for community involvement. She has also developed resources to enhance understanding of ageing among older individuals with learning disabilities.



Tess Hartland

PhD researcher, Manchester Institute for Collaborative Research on Ageing

Tess Hartland is a PhD researcher in Sociology at the University of Manchester's Urban Ageing Research Group, focusing on older refugees and asylum seekers in Manchester. She co-produced a comic book titled "Echoes of Displacement." Tess holds degrees in Global Health and Biomedical Science, with research interests in ageing, migration, social justice, and health.

Breakout sessions - Morning

Creating age-friendly businesses

White Room

Creating more age-friendly businesses - whether that's shops, cafes, leisure centres or many more - is a priority for many Age-friendly Communities. But sometimes "making the case" to those local businesses can be a challenge.

In this session we will hear directly from local business representatives about how they are making their businesses more age-friendly, and the approaches you can take to win the hearts and minds of businesses in your area



Charlotte Lewis

Senior Programme Manager (Localities), Centre for Ageing Better

Charlotte manages the UK Network of Age-friendly Communities, inspiring and supporting members, while expanding the network. Since joining the Centre for Ageing Better in September 2020, she has worked on innovation projects to promote healthy, active living and fulfilling work for older adults.



Kye Whitehouse

Guest Experience Manager, Trinity Shopping Centre, Leeds

With a decade of experience in prime shopping centres, I dedicated six years to Meadowhall and four years to Trinity Leeds. Kye's commitment to enhancing guest experiences drives her to ensure that every visitor enjoys their time, encouraging them to return repeatedly. She is passionate about pushing the limits to improve accessibility and inclusivity for all.



Rachel Woodward Carrick

College Director, Bournemouth University International College and Board member of Bournemouth Town Centre BID

Approaching her 60th birthday, Rachel chose to prepare for later life by writing Happy Silver People, offering practical advice for aging happily and healthily. Since its release in late 2022, she has applied these recommendations herself and worked to make her community more age-friendly. She collaborates with Bournemouth Town Centre BID, the Centre for Ageing Better, and the local authority to improve high street businesses for older customers.



Leila Bendrimia

Community Sport and Health Manager for Manchester, Greenwich Leisure Limited

Leila is a Community, Sport, and Health Manager with over 20 years in the sport and leisure industry. She focuses on increasing access to physical activity and develops health programmes for Manchester residents. At GLL Manchester, she supports 21 facilities, including national centres and community hubs, ensuring strategic planning and stakeholder collaboration to promote healthier lifestyles.

Dying well in Age-friendly Communities

Training Room

An Age-friendly Community is one that works for people across the lifecourse, and supporting end of life and dying well is no exception. In this session we will hear from representatives from hospices, compassionate communities and public health to consider how the community can support dying well for local residents, starting with understanding what your community wants and needs.

Sharon Williams

Project Manager, Compassionate Communities
Northern Ireland



Sharon empowers individuals and builds resilient communities through community engagement and advance care planning. She has partnered with Age Friendly Officers and stakeholders in Northern Ireland and the Republic of Ireland, leading initiatives like a regional awareness campaign and Death Positive Libraries. Sharon advocates for advance care planning to address important questions, helping focus on priorities and sharing decisions with loved ones. She supports living well today while planning for tomorrow.

Dr Mary Hodgson

Director of Inclusion & Social Innovation, St
Christopher's Hospice



Mary Hodgson is the Director of Inclusion & Social Innovation at St Christopher's. She leads efforts to address health inequalities and enhance community involvement in healthy dying. With a research and social innovation background, Mary has worked for LSE, The Young Foundation, Shelter, and various universities. She specializes in partnership working and holds a PhD in Anthropology.

Building Age-friendly and Inclusive Rural Communities

Boardroom

Older people living in rural areas can face challenges around staying connected (digital and transport), accessing health and care, or the right housing. Climate/weather factors can also have an outside impact. At the same time rural areas can be great places to grow older. Older people form the backbone of many communities and report greater health and wellbeing than urban areas, as well as access to the great outdoors.

This panel shares learning from rural communities across Wales, Ireland and the Nordic region on how to continue to thrive at any age despite, and sometimes because, of the challenges.



Chair

Natalie Turner

Deputy Director for Localities, Centre for Ageing Better

Natalie aims to create better living conditions for older adults. Her team collaborates with Greater Manchester, Leeds, and Lincolnshire, and supports the UK Network of Age-friendly Communities, an affiliate of the WHO's Global Network for Age-friendly Cities and Communities. Since 2010, she has worked on ageing issues locally, nationally, and internationally. She previously worked at AARP in Washington, DC, and Age UK London, translating international practices for a US audience.

Karen Fennessy

Regional Programme Manager, Healthy Age Friendly Homes Programme, Age Friendly Ireland



Karen has over 20 years of experience in Local Government in Ireland, focusing on Age Friendly initiatives for the last 7 years. She led projects such as the first Age Friendly Airport globally and developed Age Friendly Towns in western Ireland, recognized by the WHO. Currently, Karen is the Regional Programme Manager for the Healthy Age Friendly Homes Programme, a government-funded service that supports people over 65 to live well at home.

Louise Scheel Thomassen

Senior Adviser, Nordic Welfare Centre



Louise Scheel Thomassen is a Senior Adviser at the Nordic Welfare Centre in Stockholm, under the Nordic Council of Ministers. She focuses on issues related to older adults, ageing, and age-friendly communities. The Centre develops welfare initiatives in the Nordic region by sharing knowledge through publications, events, and coordinating expert networks.



Dave McKinney

Ageing Well Lead, Office of Welsh Older People's Commissioner

David is the Ageing Well Lead for the Older People's Commissioner for Wales. He supports individuals, organisations, and communities in developing Age-Friendly Communities across Wales. He focuses on innovative ways to help older people age well and has a strong interest in coproduction and participative approaches within Age-Friendly Communities.

Getting started with working with older residents

Connect Room

Facilitated by Good Practice Mentors, this breakout session is a 101 for early stage network members or age-friendly leads on how to work well with older people in your age-friendly community- from engaging a range of residents to setting up your co-production approach for success.



Jennie Shrewsbury

Programme Lead, Good Practice Mentor Programme

Jennie Shrewsbury is one of the Good Practice Mentors from South Yorkshire Housing Association (SYHA). She specialises in using co-production to highlight the voices of people who use services, and how to use strengths-based practice to get the most out of your conversations. Jennie is passionate about creating spaces for people to share their stories.



Jo Stapleton

Good Practice Mentor, Age UK Camden

Jo Stapleton is the Good Practice Mentor from Age UK Camden. The Good Practice Mentor Programme is an innovative national partnership born out of the seven-year Ageing Better programme. As a mentor, Jo shares learning around how to reach the people that consider groups, activities and services to be 'not for me'.

Lunch

Networking session

An opportunity for communities to come together around topics of interest and get to know their fellow network members.

Network members will have the opportunity to identify areas they are “seeking” to make connections around and practices and experiences they can “share” other network members.

Breakout sessions - Afternoon

Understanding the impact of your age-friendly community

Boardroom

Demonstrating the impact of your age-friendly community is essential, to both understand what is working well and to help make the case for continued investment and support. This session will utilise the framework developed in the UK Network of Age-friendly Communities Impact Report as a model for understanding your impact on your local system and on older residents.



Dr Emma Butcher

Senior Consultant, Urban Foresight

Emma is an epidemiologist skilled in evidence-based methods to address health inequalities and improve population health. Previously, she worked as a medical writer creating communication materials for various therapy areas. She excels at synthesising, interpreting, and communicating information, using quantitative, qualitative, and review methodologies for detailed analysis.



Charlotte Lewis

Senior Programme Manager (Localities), Centre for Ageing Better

See above.

This session is designed for earlier stage communities or those looking to refresh their action plan, to get started with mapping the policies, services and practices already in place in your area which are age-friendly. The session will help you consider your existing strengths and what might be next and will utilise the newly published Mapping Tool as part of the Age-friendly Communities Handbook



Bianca Rossetti

Strategic Partnership Manager – Greater Manchester, Centre for Ageing Better (GMCA)

Bianca works with the Ageing Better Localities Team and the GM Ageing Hub to spread age-friendly practices nationwide. Bianca was a Project Officer for the Bristol Ageing Better programme, addressing loneliness in older adults through a seven-year programme. Recently, she managed Age-friendly Bristol, developing strategies and engagement tools to enhance the city's services for older people.

Becoming an Age-friendly leader

Training Room

This session will explore the role of the Age-friendly coordinator and how to become a local leader for age-friendliness. The session will bring together learning from the UK and internationally and will use the newly published Age-friendly leadership handbook



Paul McGarry

Assistant Director of Public Service Reform and Head of the GM Ageing Hub, GMCA

Paul McGarry, head of GMCA's Ageing Hub since 2016, is Assistant Director of GMCA's Public Service Reform Directorate. Paul is a founding member of WHO's Global Network and the UK Network of Age-Friendly Cities and Communities, and a research fellow at Manchester University. He has been honoured with the "United Nations Healthy Ageing 50" title and the British Society of Gerontology's "Outstanding Achievement Award" for his significant contributions to gerontology.



Anne Berit Rafoss

Project Manager, Centre for an Age-Friendly Norway

Anne Berit Rafoss has spent 12 years promoting age-friendly development. She developed Oslo as an age-friendly city, led "Urban Ageing" in Eurocities, and worked at WHO Geneva on age-friendly projects. She created Norway's network of age-friendly cities, hosted by the Centre for an Age-Friendly Norway/Norwegian Directorate of Health, where she now manages national and international efforts focused on older people's involvement, collaboration, and sustainable development.



Tom van Bentem

Strategic Policy Advisor, Age-friendly Amsterdam (Invited)

Tom has worked 5 years at the regional level of the province of Noord-Holland supporting cities in their policy tasks in the field of youth and well being. Now Tom is a strategic policy advisor at the public health department of the city of Amsterdam. Advisor to management and politicians on public health, including urban ageing and HIV/AIDS. Involved with the reference city of the Amsterdam metropolitan area since 2016. Chair of the working group urban ageing at Eurocities, an organisation representing cities larger than 250,000 inhabitants in Europe.



Natalie Turner

Deputy Director for Localities, Centre for Ageing Better

See above.

Chair



Laura Poskin

Executive Director, Age-friendly Pittsburgh

Laura Poskin is a gerontologist and passionate advocate. Over the past nine years, she has built a coalition of 120+ organizations at Age-Friendly Greater Pittsburgh, a leader in the U.S. Network. Laura studied aging and demographic change at Miami University in Ohio (USA) and Mahidol

Taking your co-production work to the next level

Connect Room

Facilitated by Good Practice Mentors, this session is for more advanced practitioners and Age-friendly Communities to consider how to build on their current engagement work and consider how to further put coproduction at the heart of their work, learning from emerging models and practice.



Jennie Shrewsbury

Programme Lead, Good Practice Mentor Programme

See above.



Jo Stapleton

Good Practice Mentor, Age UK Camden

See above.

Celebrate Ageing, Challenge Ageism

Elliot Suite

A performance from local older residents bringing a creative representation of Celebrating Ageing and Challenging Ageism, ahead of the this year's Age Without Limits Action Day

ArtBeat is The Octagon Theatre's group for over 50's to develop their drama, confidence, and communication skills, explore their creativity and meet new people in a safe, collaborative, and encouraging environment. Last year they took part in the Ageism Action Day with Ageing Better. They commissioned a local professional writer to run a creative writing workshop with 10 over 50s local writers, for them each to develop a short play about challenging ageing and ageism. The pieces were then performed by their Artbeat group. We are honoured to have been asked to share one of them with you today.

Writer: **Molly Williams**

Actors: **Michael Morris, Josie Byrne**

Wrap up and close

Elliot Suite

This final session will close the UK Network of Age-Friendly Communities Conference. Thank you for attending, we look forward to working with you in the future.

**Thank you for
attending the Age-
Friendly Futures
Summit.**

Floor plan

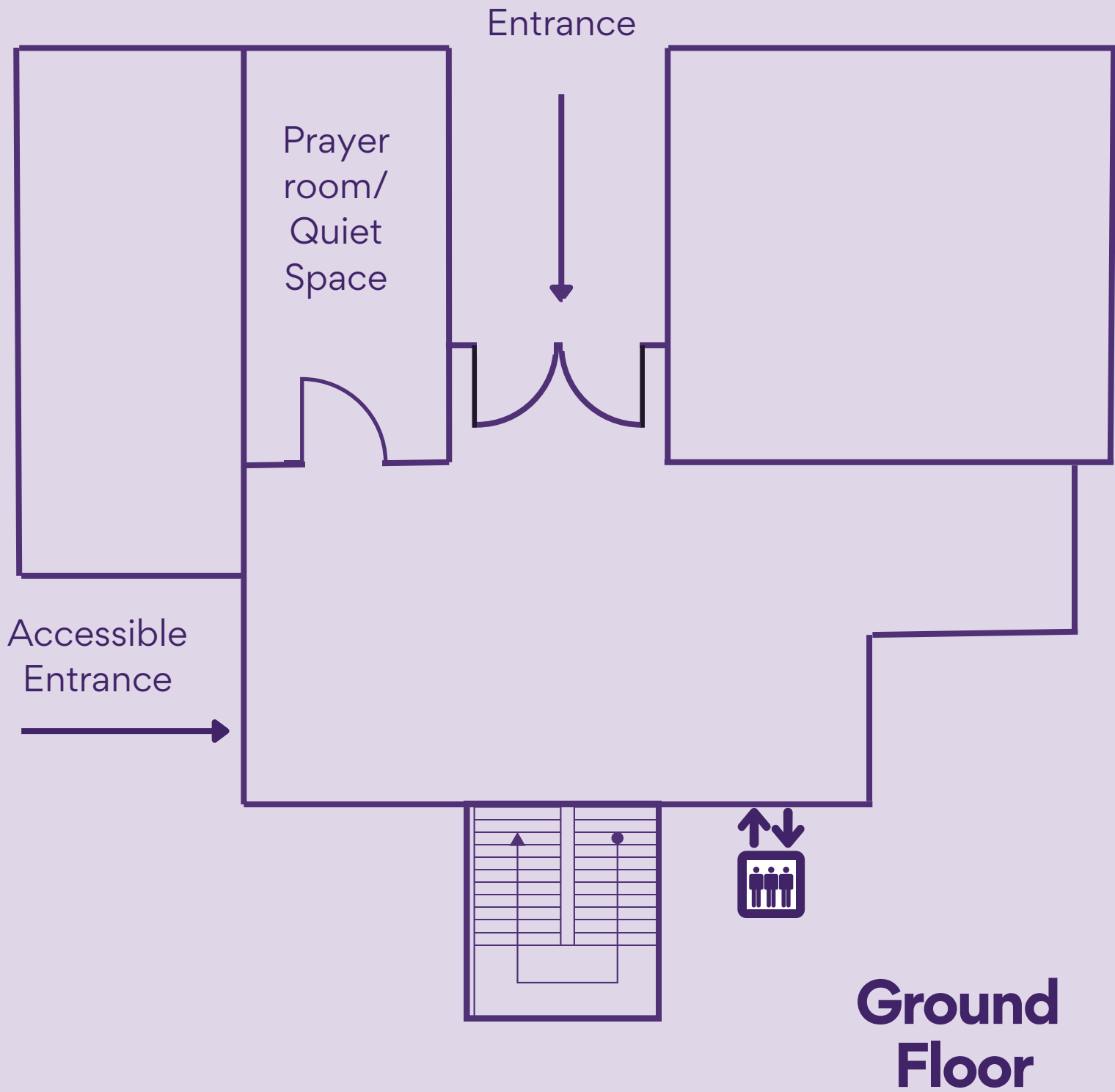



Attendees of Age-Friendly Futures have exclusive access to floor 2, whereas other areas of the venue, such as the Members lounge are open to Chamber Space members.

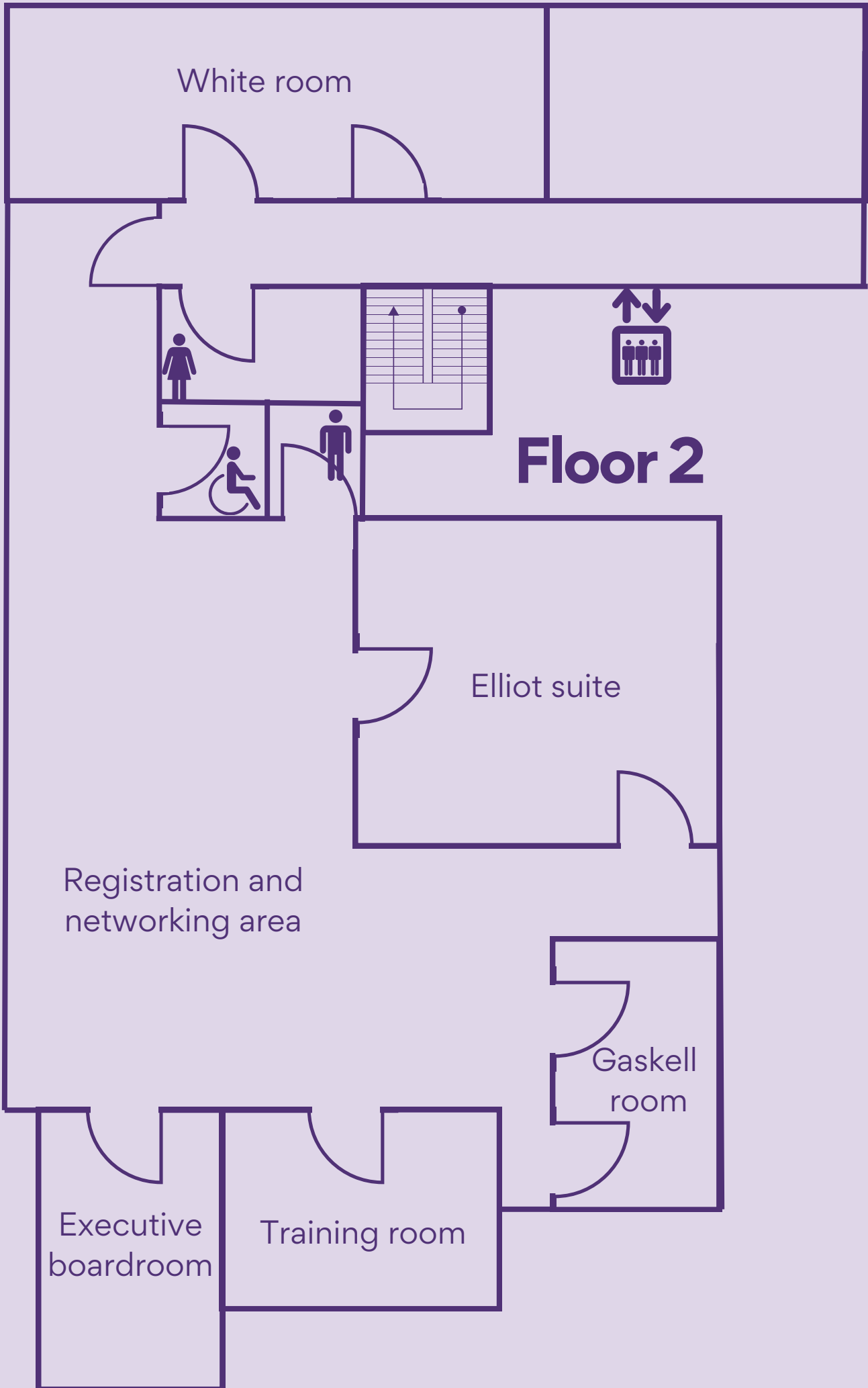



Age-Friendly Futures Summit

We look forward to working with you in the future.

If you have any questions or feedback, please contact
agefriendlyfutures@oddityevents.com

